



ECHO

Portable Toilet

ASSEMBLY MANUAL

ALL RIVET DESIGN



STRONG. SMART. DURABLE.

jjportable.com



Echo Toilet Parts Key Exploded View

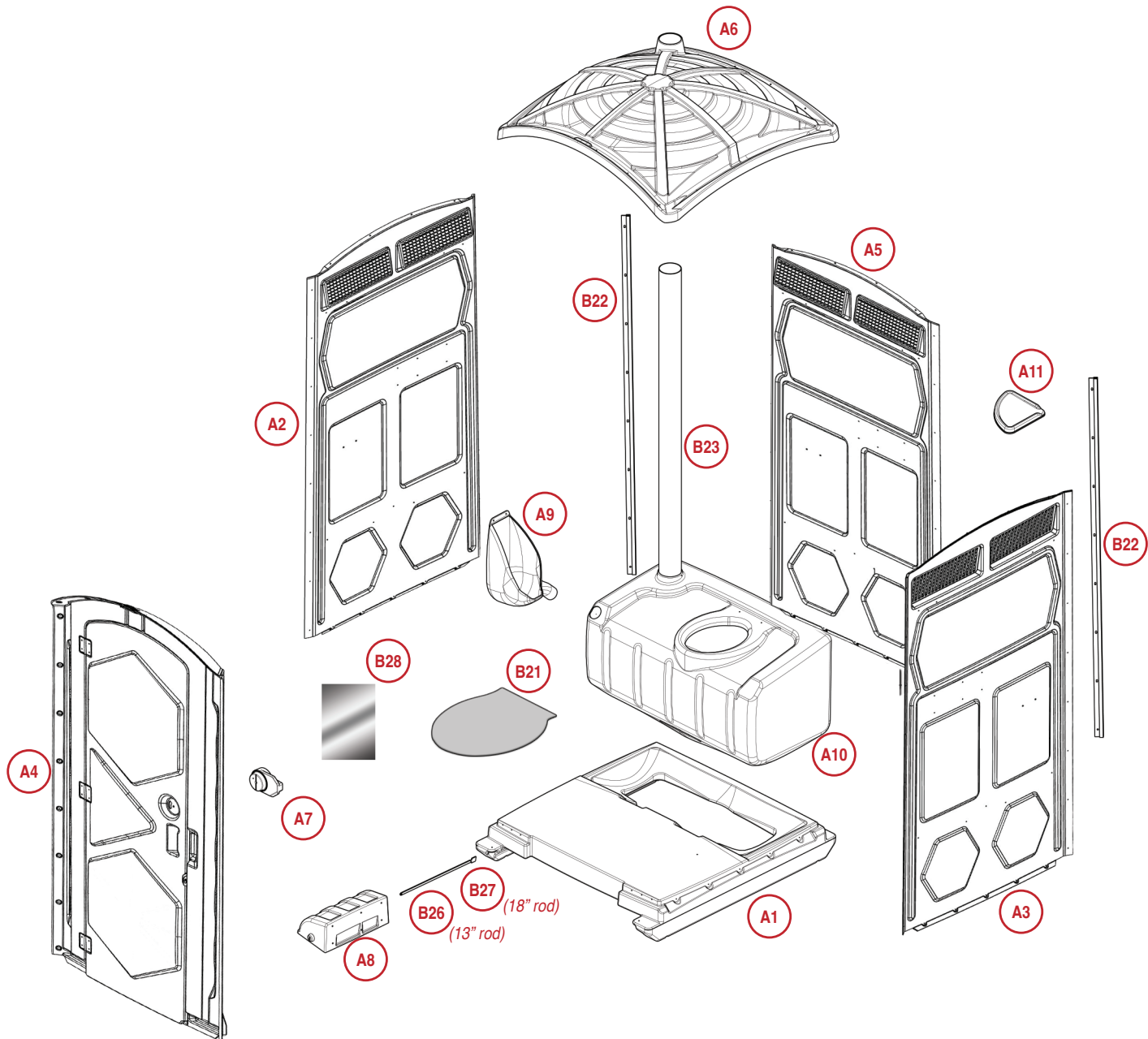

- A1 Base
- A2 Side Panel
- A3 Side Panel
- A4 Front Panel
- A5 Side Panel
- A6 Roof
- A7 Door Latch
- A8 Toilet Paper Holder
- A9 Urinal

- A10 Tank
- A11 Shelf
- B21 Toilet Seat
- B22 T-Mold Strip
- B23 Vent Stack
- B26 Toilet Paper Rod 13"
- B27 Toilet Paper Rod 18"
- B28 Mirror

ASSEMBLY INSTRUCTIONS FOR ECHO PORTABLE TOILET

Required tools for assembly:

- Electric or Cordless drill
- 3/8" nut driver
- 7/16" nut driver
- 3/16" drill bit
- 3/8" drill bit
- 7/16" wrench
- Screwdriver cross-tip
- Rivet gun / rivet tool

Recommended: second cordless drill, 4 pairs of vice clamps, punch set, marker, locks for doors

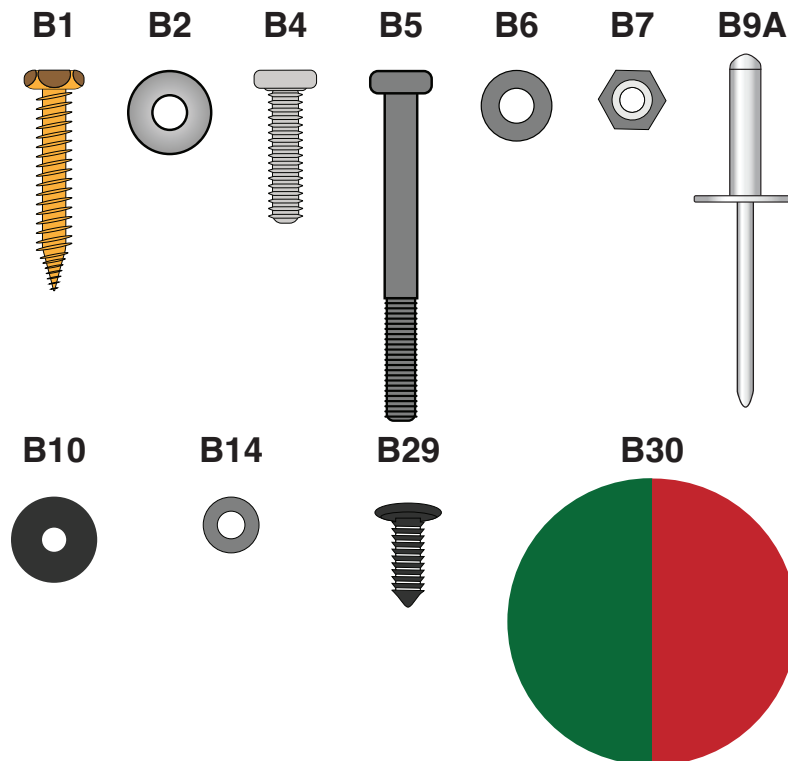

- B1 #14 x 1 1/2" gold high low screw
- B2 #14 x 5/8" OD bonded washer
- B4 1/4" x 1" stainless steel bolt
- B5 1/4" x 2 1/2" stainless steel bolt
- B6 1/4" flat stainless steel washer
- B7 1/4" stainless steel lock nut
- B9A rivet large flange 3/16"
- B10 rubber washer 5/8" x 3/16"
- B14 rivet washer 3/16" stainless steel
- B29 mirror anchor black plastic
- B30 Red/Green label

STEP 1. ASSEMBLE SIDES AND BACK

Parts required:

- 3- Side Panels
- 2- T-Mold Strips
- 16- Pop rivet, large flange
- 16- Rivet washer 3/16" stainless steel

1. Lay one panel on a table or bench approximately 42 inches in height.
(Tank can be used as this support by standing on end.)
2. Align corners of side panels with this panel. Place T-Mold strip over edges of panels and align predrilled holes in panels and T-Mold strip. (T-mold strip should not extend past bottom of wall panels.)
3. Insert pop rivet through holes from underneath and apply rivet washer over rivet end. Rivet washer will be visible on panel that is laying down, this will ensure all rivet ends are at back of toilet.
4. Using rivet gun, secure rivet and rivet washer.
5. Repeat process to secure remaining rivets and rivet washers.

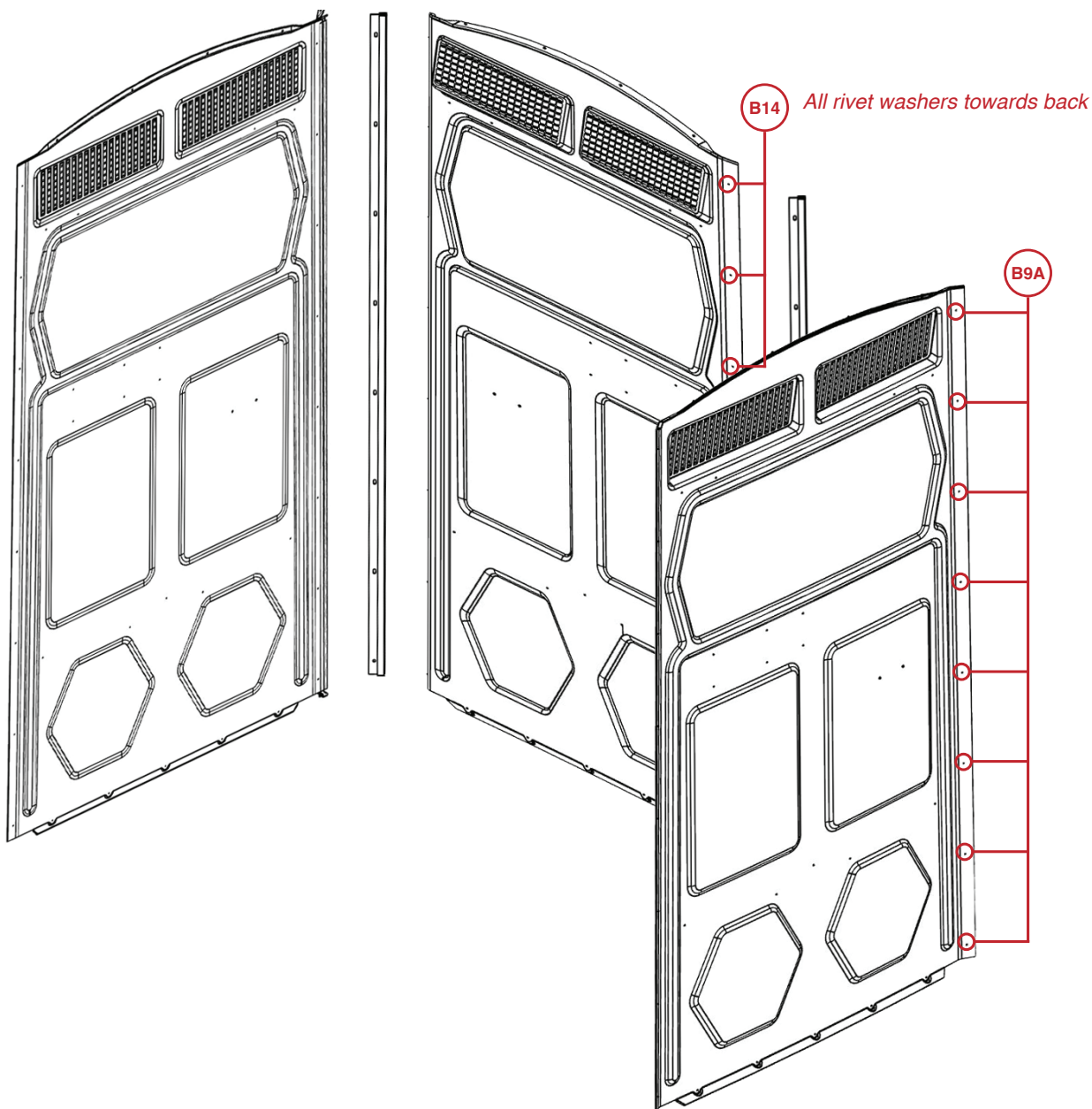

STEP 2. ATTACH BASE

Parts required:

- Base
- Tank
- Vent Stack
- 4- 1/4" x 1" stainless steel bolt
- 3- #14 x 1 1/2" gold high low thread screw
- 7- #14 x 5/8" OD bonded washer

1. Use 3/8" drill bit to drill and enlarge predrilled holes along bottom of wall panels if not already done so.
2. Align base with opening facing up. Align holes in panel with pre-seated rivnuts in base. To prevent cross-threading, insert 1" bolt with bonded washer through hole in panel and into seated rivnut and finger tighten. The pre-seated rivnuts are located at the corners of base and top of each side. Once all four bolts with bonded washers have been inserted, use a 7/16" nut driver to secure the bolts, careful not to over tighten.
3. Using a 3/8" nut driver, insert #14 x 1 1/2" gold high low thread screws with bonded washers into the remaining holes and into base to secure. Do not over tighten.
4. Stand toilet upright on base. Place tank in opening of base at back panel with opening for vent stack to the left. Insert vent stack into opening of tank at back left corner.
5. Lay toilet on its back.

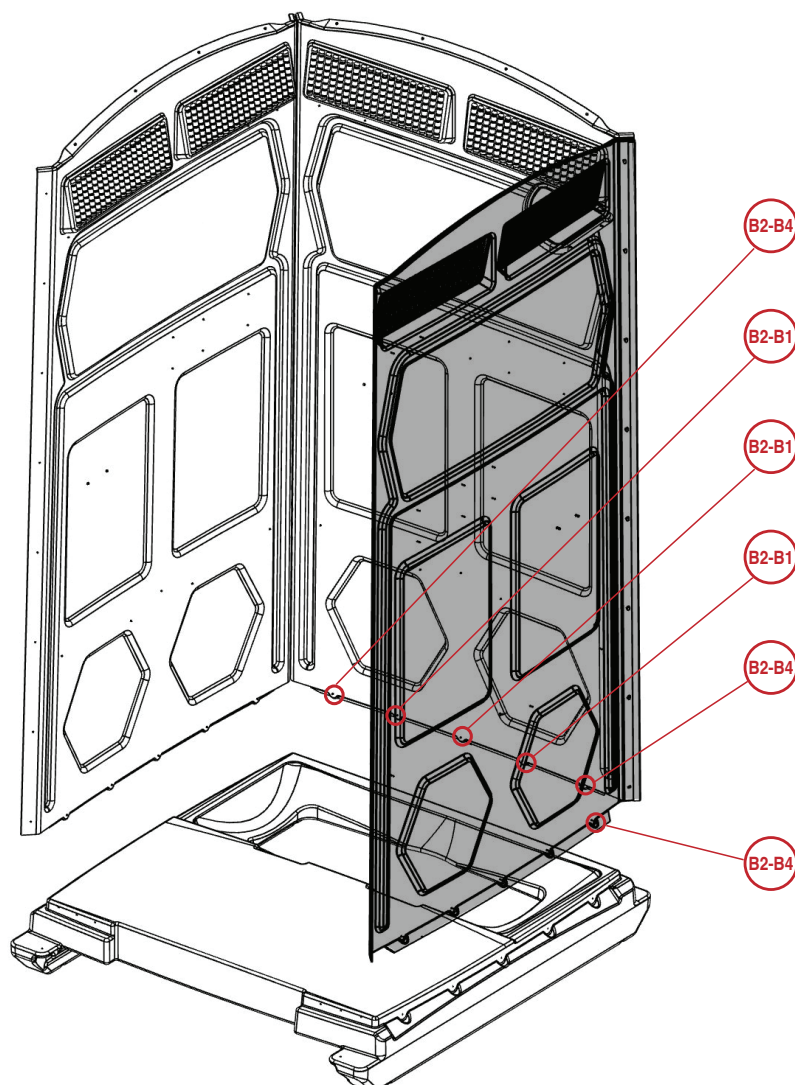

STEP 3. INSTALLING FRONT PANEL

Parts required:

- Front panel assembly
- 2- ¼" x 1" stainless steel bolt
- 4- #14 x 1 ½" gold high low thread screw
- 6- #14 x 5/8" OD bonded washer
- 16- Pop rivet, large flange
- 16- Rivet washer 3/16" stainless steel

1. Use 3/8" drill bit to drill and enlarge predrilled holes along bottom of front panel if not already done so.
2. With toilet on its back and assistance from another person lay front panel onto base and side panels.
3. Align center holes on each side of panel with pre-seated rivnuts in base. Insert ¼" x 1" stainless steel bolt with bonded washer and finger tighten. Use 7/16" nut driver to secure, careful not to overtighten.
4. Using 3/8" nut driver insert #14 x 1 ½" gold high low thread screws with bonded washers through predrilled holes and into base. Do not overtighten.
5. Align predrilled holes in front panel with predrilled holes of side panel. Insert pop rivet so that flange or rivet is against front panel. Place rivet washer over rivet end. Use rivet gun/ rivet tool to secure rivet and washer.
6. Repeat process to secure remaining rivets and rivet washers.
7. Stand toilet upright.

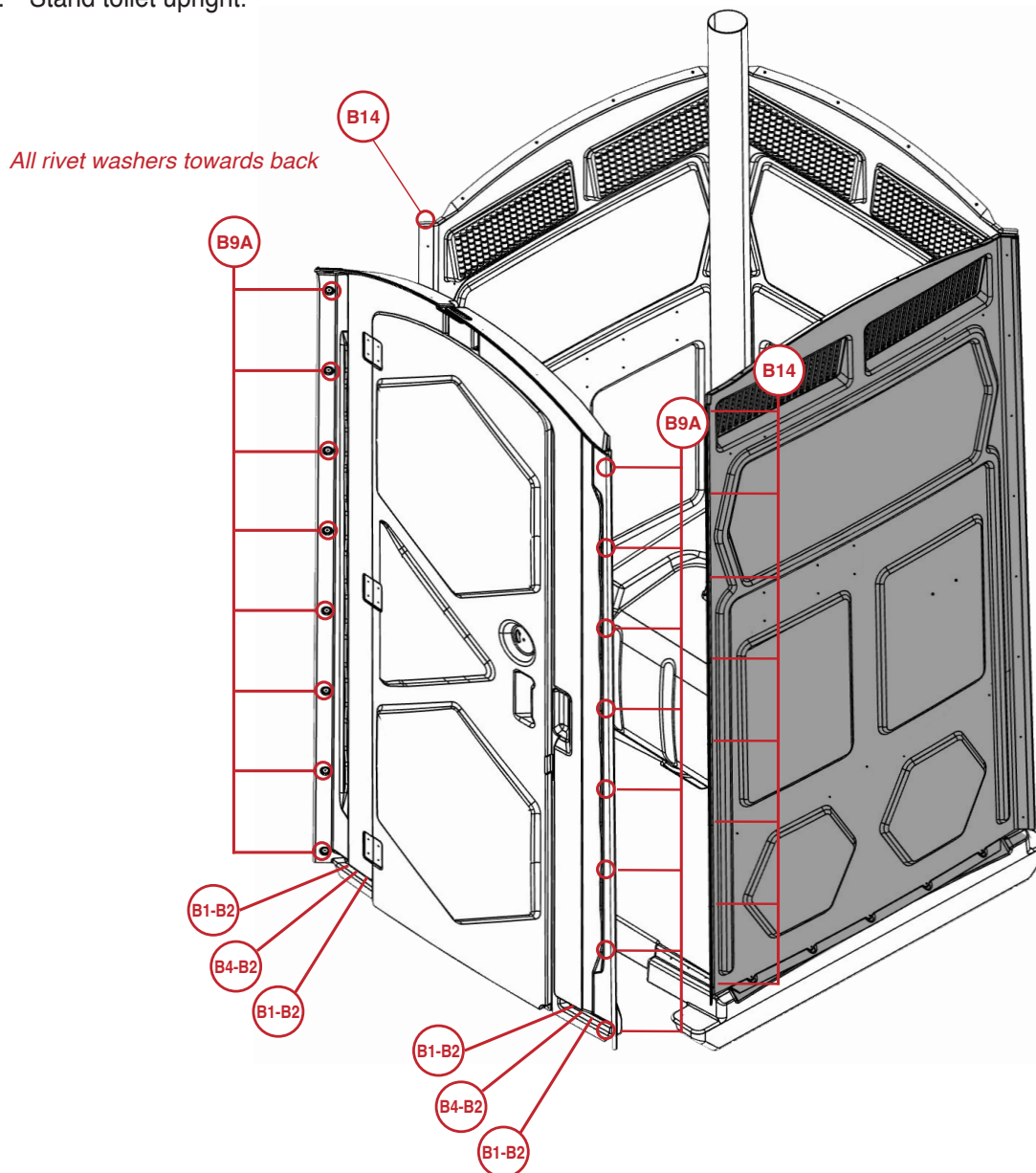

STEP 4. INSTALLING THE ROOF

Parts required:

- Roof
- 18 - Pop rivet, large flange
- 18 - Rubber washer 5/8" x 3/16"
- 18 - Rivet washer 3/16" stainless steel

1. Place roof on top of walls, with hole for vent stack at back left corner of toilet.
2. Align roof at front panel, holding down corners securely on top of walls. Check roof to ensure proper fit.
3. Insert pop rivet, with rubber washer, from roof side through hole in roof and front panel. Place rivet washer over rivet end. Using rivet gun/rivet tool, secure rivet and rivet washer.
4. Repeat process for remaining four predrilled holes of front panel to secure roof to front panel.
5. Move to back panel of toilet. Hold roof down at corners to fit properly. Insert pop rivets with rubber washers, from roof side through holes in roof and back panel. Place rivet washer over rivet end. Secure rivets and rivet washers.
6. Repeat process for remaining side, being sure to hold down corners for proper fit.
7. Note: All rivet flanges and rubber washers should be on top side of roof and rivet washers under lip of roof.

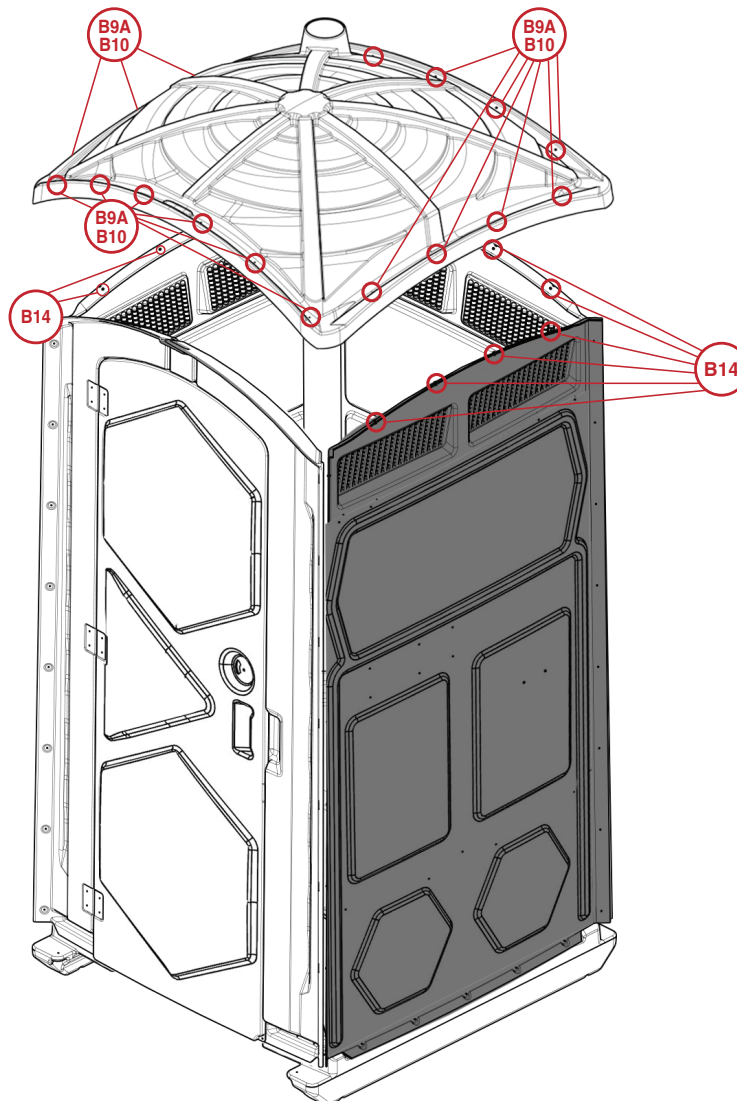

STEP 5. SEAT TANK AND INSTALL VENT STACK

Parts required:

- 16- #14 x 1 ½" gold high low thread screw
- 16- #14 x 5/8" OD bonded washer

1. Using 3/8" nut driver, install #14 x 1 ½" gold high low thread screws and bonded washers through remaining predrilled holes at bottom of panel walls and into base to secure. Do not overtighten.
2. With another person holding the tank securely in the tank rest of the base, use 3/8" nut driver to install #14 X 1 ½" gold high low thread screws with bonded washers into predetermined drill starts on side and back of toilet and into tank to secure. Do not overtighten. See three panel insert for start locations.
3. Push vent stack end through vent stack hole in roof. Set vent stack to desired height. Using 3/8" nut driver insert #14 x 1 ½" gold high low thread screw with bonded washer into drill start on tank lip at vent stack opening to secure vent stack.

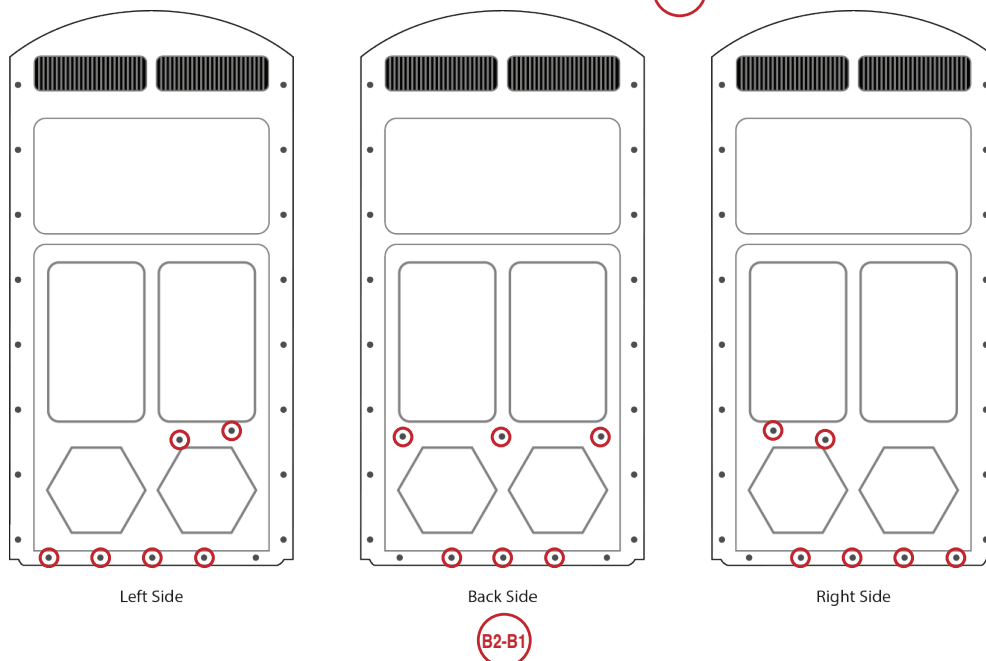
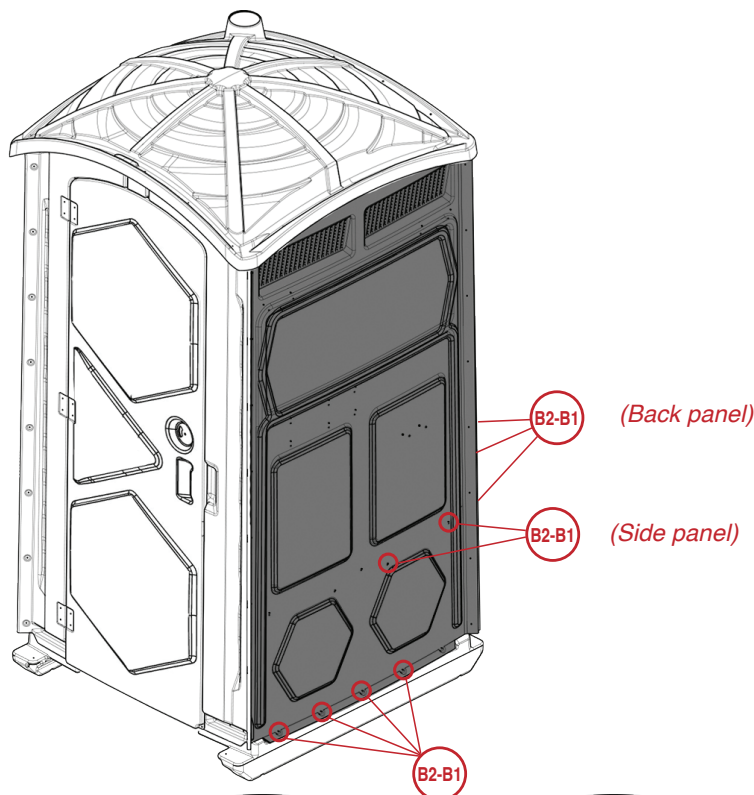

STEP 6. SECURING THE URINAL

Parts Required:

- Urinal
- 3 - Rivet large flange 3/16"
- 3 - rivet washer 3/16" stainless steel

1. With urinal tube inserted into small opening at front left of tank, ensure proper seating of urinal by aligning mounting hole in urinal top with pre drill marks on side panel.
2. Using 3/16" drill bit, drill holes through side panel using mounting holes in urinal as guide.
3. Insert rivets from outside the toilet through the holes in toilet wall and urinal. Place rivet washers over ends of rivets and secure using rivet gun/ rivet tool.

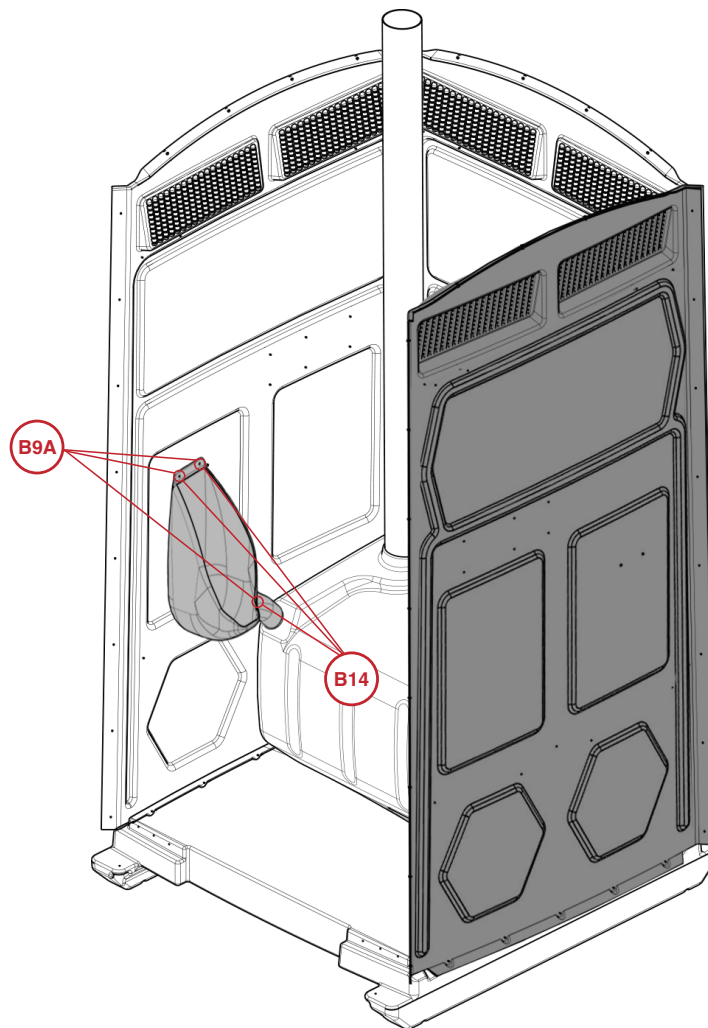

STEP 7. INSTALLING TOILET PAPER HOLDER AND ROD.

Parts required:

- Toilet paper holder (2 or 3 roll)
 - Toilet paper rod (2 or 3 roll)
 - 6- Rivet large flange 3/16" (only 4 needed for 2-roll holder)
 - 6- Rivet washer 3/16" stainless steel (only 4 needed for 2-roll holder)
-
1. Using 3/16" drill bit, drill the predetermined holes on side panel.
 2. Align holder with holes in side panel and drill holes in holder.
 3. Insert rivets from outside the toilet through the holes in toilet wall and toilet paper holder. Place rivet washers over ends of rivets and secure using rivet gun/ rivet tool.
 4. Insert toilet paper rod through holes on sides of toilet paper holder and secure with zip strap or lock of choice.

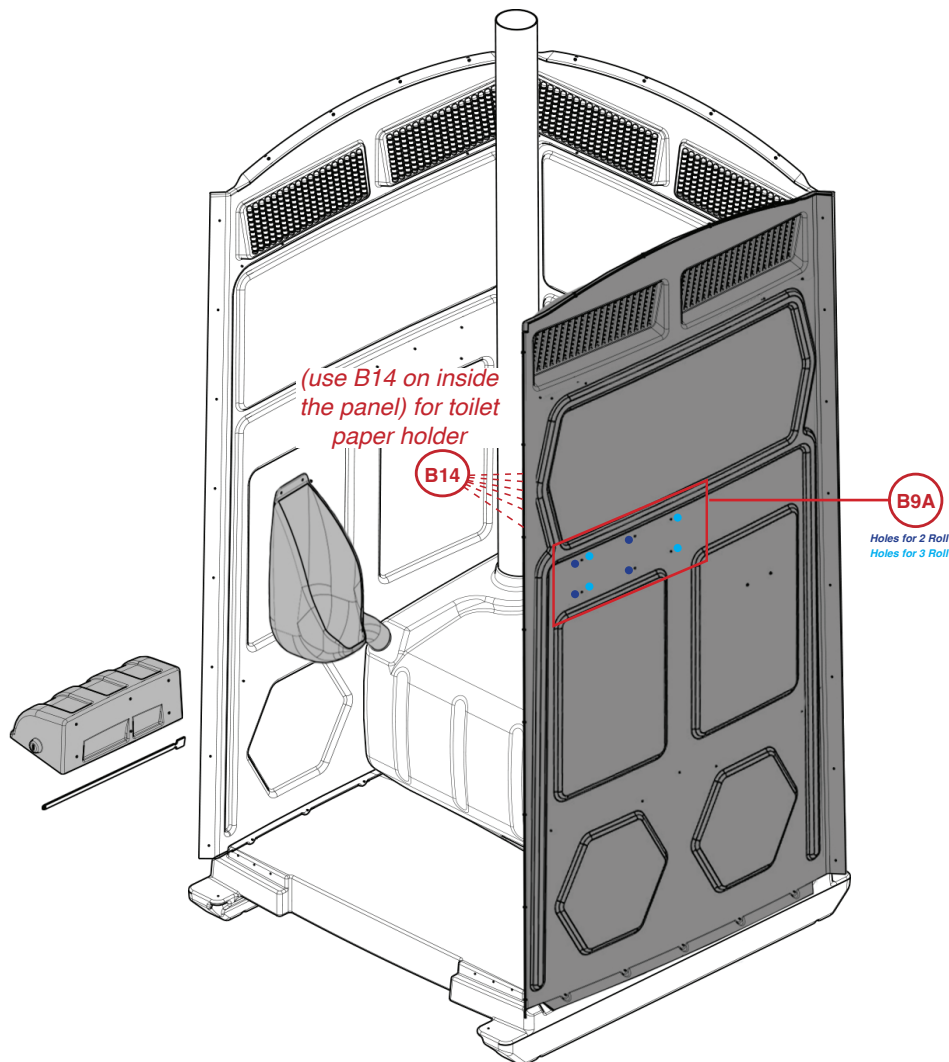

STEP 8. INSTALLING SHELF (OPTIONAL)

Parts required:

- Shelf
 - 4- Rivet large flange 3/16"
 - 4- Rivet washer 3/16" stainless steel
1. Using 3/16" drill bit, drill the drill start locations in back right corner of toilet just below vent screens.
 2. Insert pop rivets, from outside of toilet wall, through holes in panel and shelf. Start with holes farthest from corner.
 3. Place washer over rivet end and hold in place with screwdriver tip.
 4. Secure rivets using rivet gun.
 5. If holes closest to corner do not align properly, use 3/16" drill bit to drill from outside of toilet through holes you drilled at drill start and into shelf. Careful not to drill through shelf top.
 6. Insert rivets, from outside toilet wall, through holes in panel wall and shelf.
 7. Place washer over rivet end and secure with rivet using rivet gun.

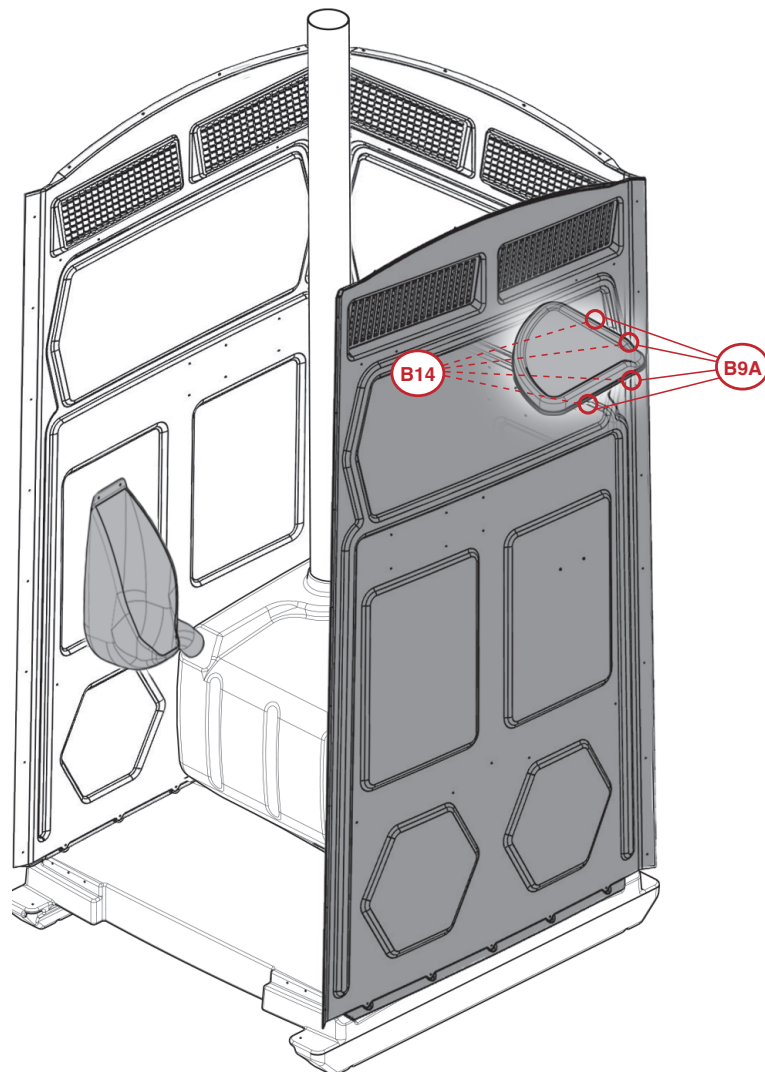

STEP 9. INSTALLING DOOR LATCH

Parts required:

- Door latch
- Red/Green label
- 1/4" x 2 1/2" stainless steel bolt
- 2- 1/4" flat stainless steel washer
- 1/4" stainless steel lock nut

1. Apply red/green label to door latch so that red show though indicator window of door when latch is in locked position. (Hold rounded part of latch in hand and align red/green label with groove in latch. Red should face down and left. Green will face up and right.)
2. Insert 2 1/2" stainless steel bolt with washer through hole in door panel near indicator window and through hole in door latch. Install the other washer and 1/4" stainless steel lock nut. Using 7/16" nut driver and 7/16" secure locknut onto bolt. Tighten so that 3 to 4 threads are visible past nut.

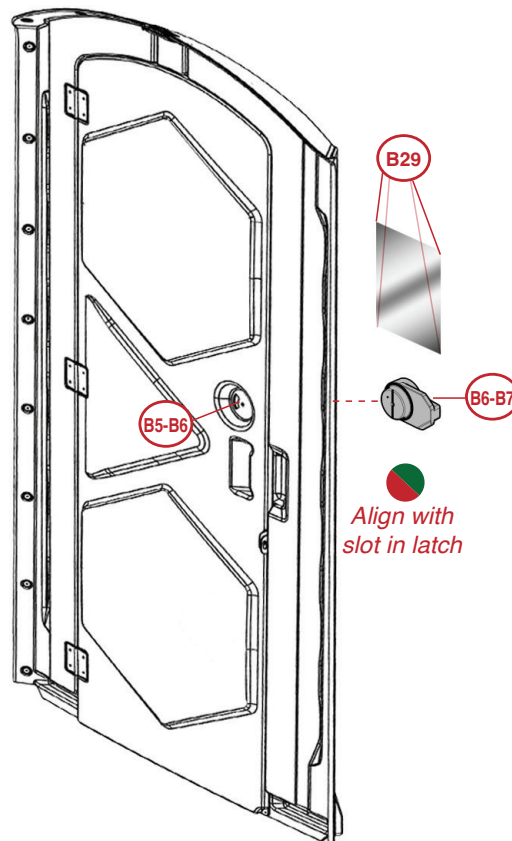

STEP 10. INSTALLING TOILET SEAT

Parts needed:

- Toilet seat with parts

1. Using parts, supplied with seat, attach seat to tank as instructed.

