



# ECHO

Portable Toilet

## ASSEMBLY MANUAL



**STRONG. SMART. DURABLE.**

[jjportable.com](http://jjportable.com)



## Echo Toilet Parts Key Exploded View

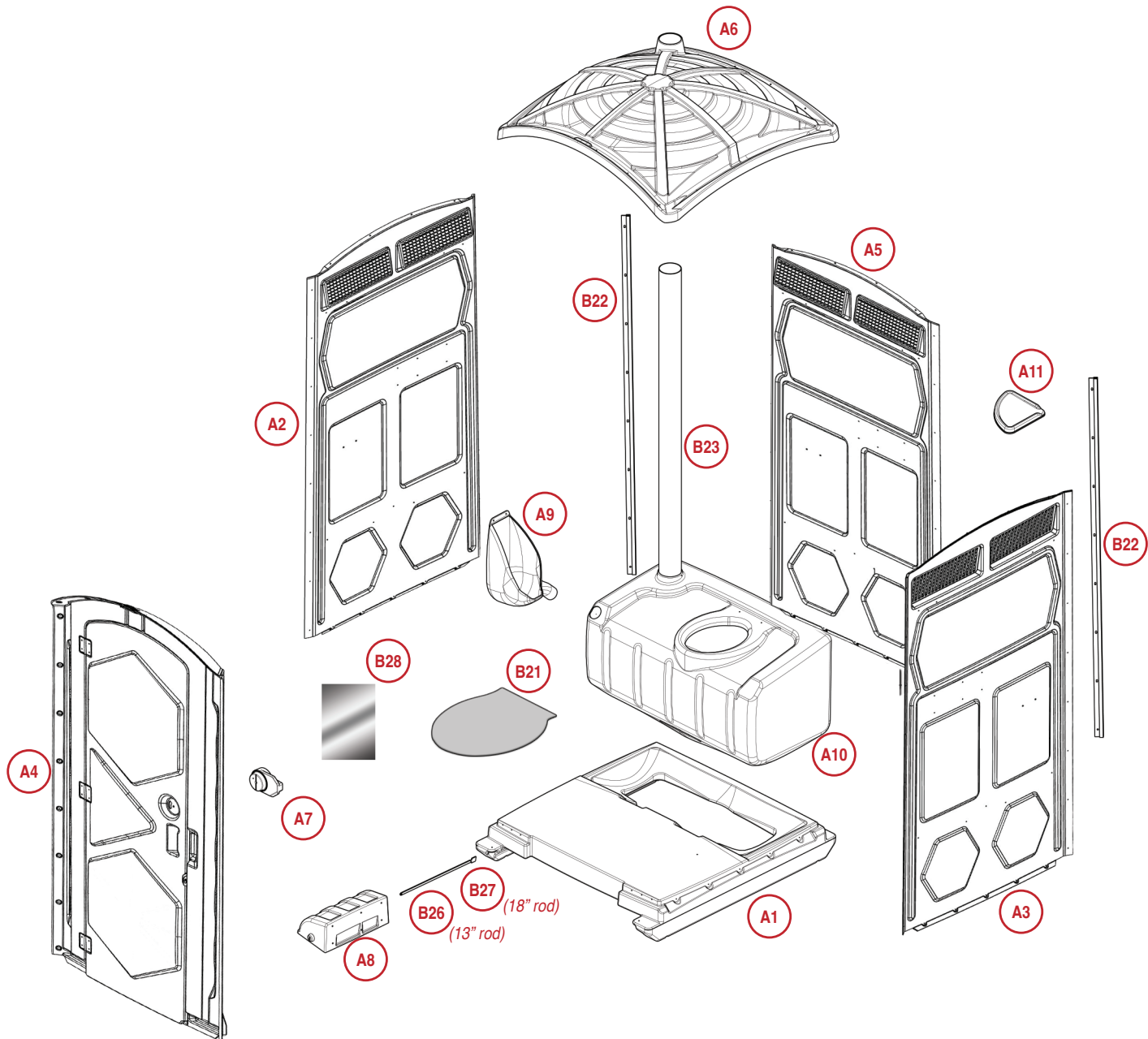

- A1 Base
- A2 Side Panel
- A3 Side Panel
- A4 Front Panel
- A5 Side Panel
- A6 Roof
- A7 Door Latch
- A8 Toilet Paper Holder
- A9 Urinal

- A10 Tank
- A11 Shelf
- B21 Toilet Seat
- B22 T-Mold Strip
- B23 Vent Stack
- B26 Toilet Paper Rod 13"
- B27 Toilet Paper Rod 18"
- B28 Mirror

## ASSEMBLY INSTRUCTIONS FOR ECHO PORTABLE TOILET

### Required tools for assembly:

- Electric or Cordless drill
- 3/8" nut driver
- 7/16" nut driver
- 3/16" drill bit
- 3/8" drill bit
- 7/16" wrench
- Screwdriver cross-tip
- Rubber mallet and wooden block
- Rivet gun

**Recommended:** second cordless drill, 4 pairs of vice clamps, punch set, zip straps, marker, locks for toilet paper rods and doors

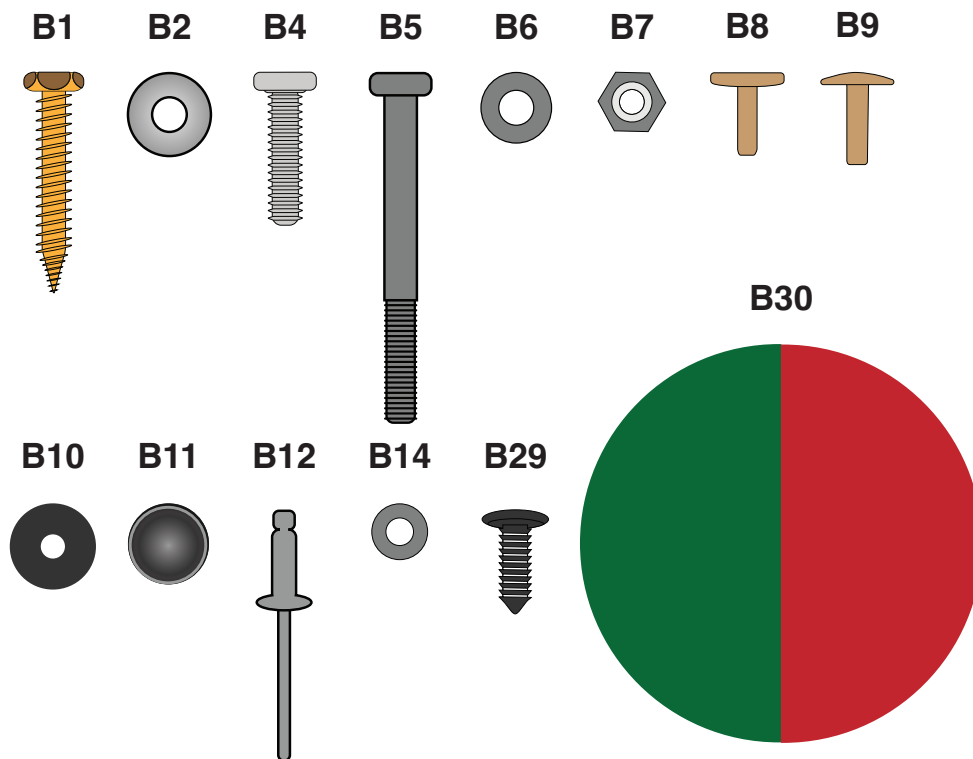

- B1 #14 x 1 1/2" gold high low screw
- B2 #14 x 5/8" OD bonded washer
- B4 1/4" x 1" stainless steel bolt
- B5 1/4" x 2 1/2" stainless steel bolt
- B6 1/4" flat stainless steel washer
- B7 1/4" stainless steel lock nut
- B8 rivet tapered end 3/16" x 9/16"
- B9 rivet tapered end 3/16" x 11/16" domed
- B10 rubber washer 5/8" x 3/16"
- B11 cap nut push black 3/16"
- B12 pull rivet 3/16"D x 3/8"G Aluminum/Steel
- B14 rivet washer 3/16" stainless steel
- B29 mirror anchor black plastic
- B30 Red/Green label

## STEP 1. ASSEMBLE SIDES AND BACK

### Parts required:

- 3- Side Panels
  - 2- T-Mold Strips
  - 16- Rivet tapered end 3/16" x 9/16"
  - 16- Cap nut push black 3/16"
1. Lay one panel on table or bench approximately 42 inches in height. (Tank can be used as this support by standing on end.)
  2. Align corners of side panel with this panel. Place T-mold strip over edges and align predrilled holes in panels and T-Mold strip. (Strip should not extend past bottom of wall panels)
  3. Insert rivet tapered end 3/16" x 9/16" through holes from underneath and apply cap nut to rivet end. Cap nuts should be facing up. (This will ensure cap nuts face back of toilet)
  4. Repeat for other side panel. Ensure all cap nuts are facing same direction. Bracing wooden block against head of rivets, bump cap nuts with rubber mallet to seat them securely.

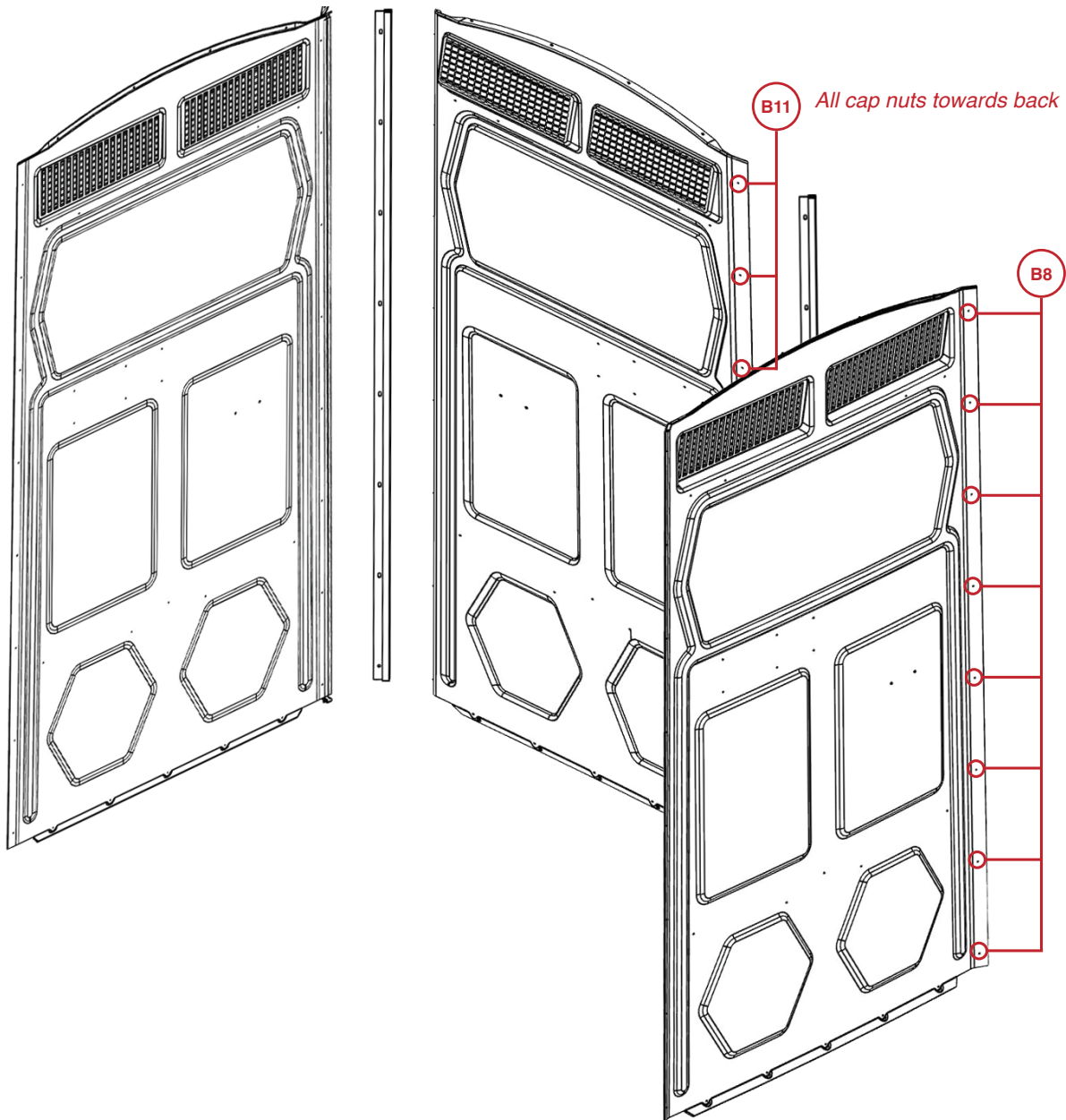



## STEP 2. ATTACH BASE

### Parts required:

- Base
- Tank
- Urinal
- Vent Stack
- 4- 1/4" x 1" stainless steel bolt
- 3- #14 x 1 1/2" gold high low thread screw
- 7- #14 x 5/8" OD bonded washer

1. **If not already predrilled to 3/8"**, use 3/8" drill bit to drill and enlarge predrilled holes along bottom of side and back panels.
2. Align base with opening facing up. Align holes in panel with pre-seated rivnuts in base. To prevent cross-threading, finger tighten 1" bolts with bonded washers through holes in panel and into seated rivnut in toilet base. Rivnuts are located at corners of base and top of each side. After all four of the bolts with bonded washers have been inserted, use a 7/16" nut driver to secure bolts, do not over tighten.
3. Using 3/8" nut driver, insert #14 x 1 1/2" gold high low thread screws with bonded washers into the three remaining holes and secure, careful not to overtighten
4. Stand unit upright on base. Place tank in opening of base at back panel with opening for vent stack and urinal to the left. Insert urinal tube into opening at front left of tank. Insert vent tube into opening at back left.
5. Lay toilet on its back.

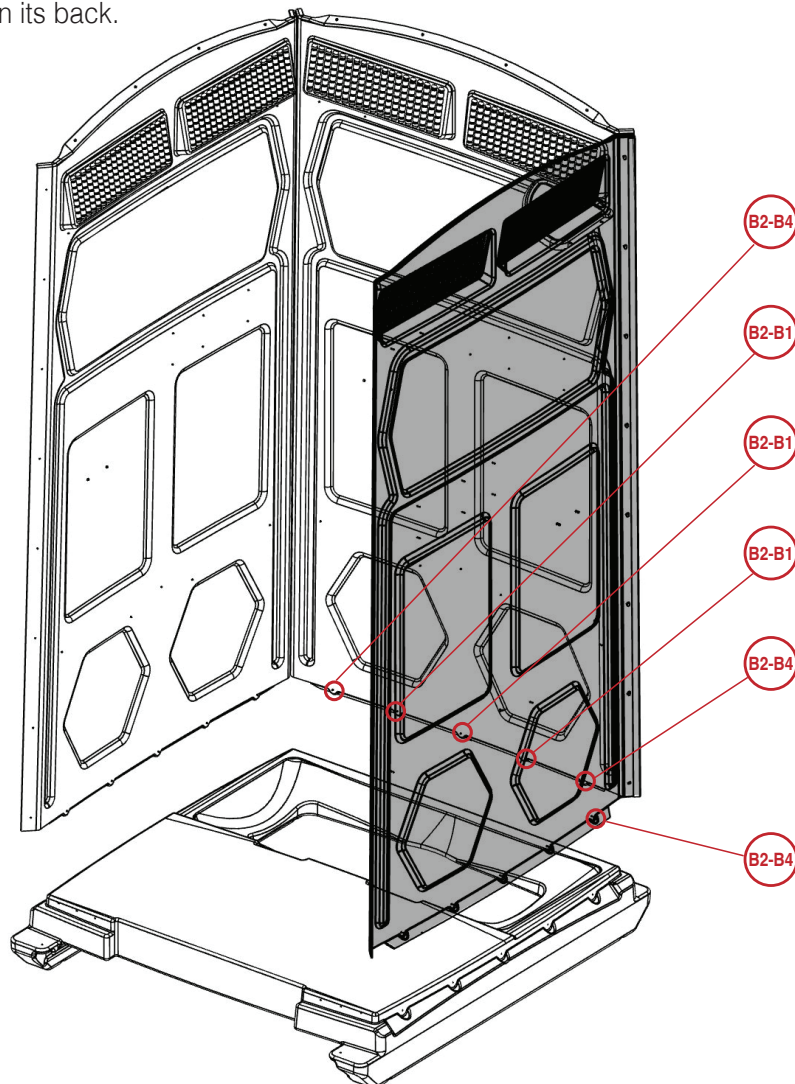

### STEP 3. INSTALLING FRONT PANEL

#### Parts required:

- Front panel assembly
- 2- 1/4" x 1" stainless steel bolt
- 4- #14 x 1 1/2" gold high low thread screw
- 6- #14 x 5/8" OD bonded washer
- 16- Rivet tapered end 3/16" x 9/16"
- 16- Cap nut push black 3/16"

1. **If not already predrilled to 3/8"**, Using 3/8" drill bit, enlarge pre-drilled holes at bottom of front panel assembly.
2. With toilet assembly on its back, lay front panel onto base and side panels.
3. Align center holes on each side of panel with rivnuts in base. Insert 1/4" x 1" stainless steel bolt with bonded washer and finger tighten. Using 7/16" nut driver, secure bolts. Do not over tighten.
4. Install 4- #14 x 1 1/2" gold high low thread screws with bonded washers in predrilled holes and into base. Do not overtighten.
5. Align predrilled holes in front panel with predrilled holes in side panels and install tapered rivets. Install cap nut on rivet end. Rivet head should at front panel and cap nut at the side. Once all rivets are installed, brace rivet heads with wooden block and bump cap nut with rubber mallet to seat them securely.
6. Stand toilet upright.

*All cap nuts towards back*

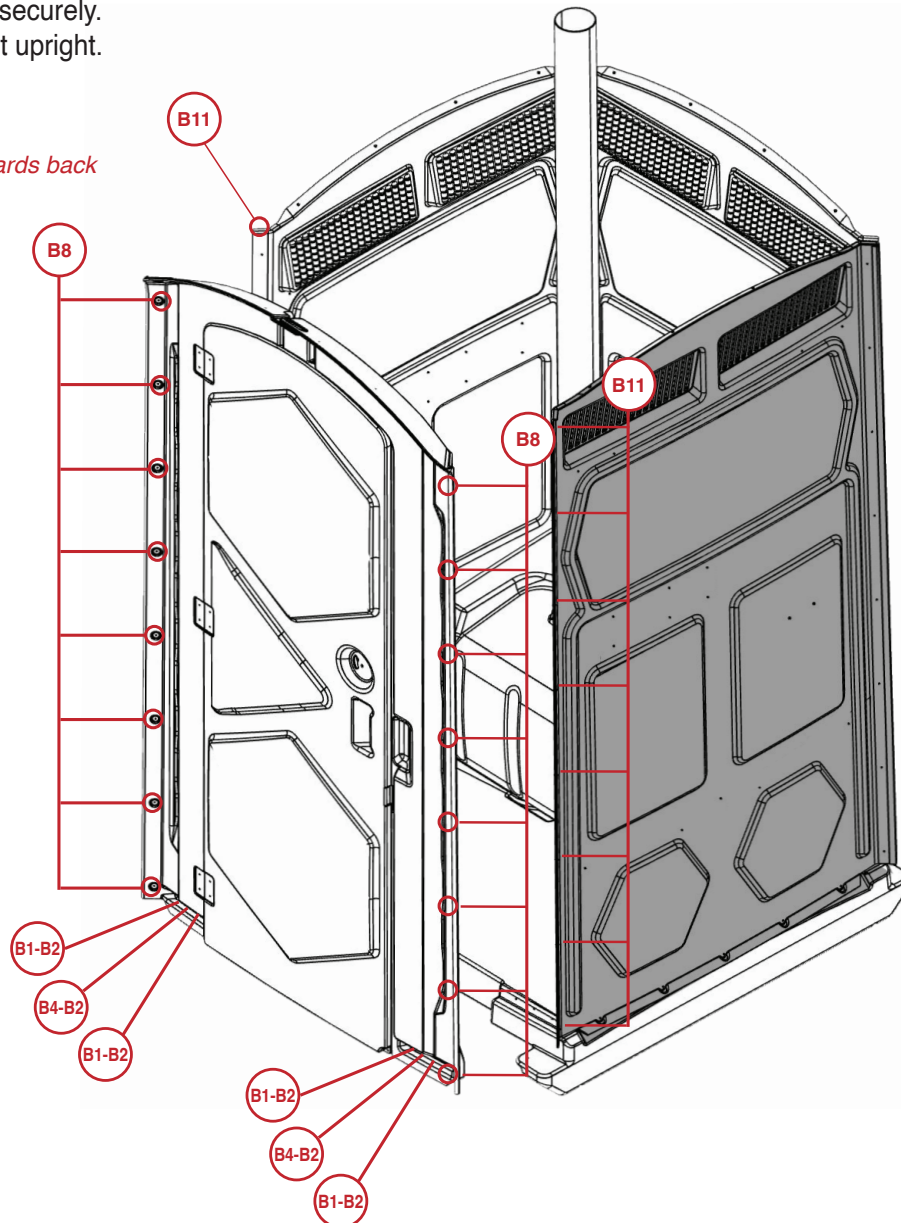

## STEP 4. INSTALLING THE ROOF

### Parts required:

- Roof
  - 12- Rivet tapered end 3/16" x 9/16" (for side panel to roof assembly)
  - 6- Rivet tapered end 3/16" x 11/16" domed (for front panel to roof assembly)
  - 18- Rubber washer 5/8" x 3/16" (used on all rivets for roof assembly)
  - 18- Cap nut push black 3/16"
1. Place roof on top of walls, with hole for vent stack at back left corner of toilet.
  2. Align roof at front panel, holding front corners down securely on top of walls. Check roof to ensure proper fit.
  3. Install rivet tapered end 3/16" x 11/16" domed with washers through holes, rivet head on roof. Install cap nut onto rivet end under lip of roof. Holding rivet heads with wooden block, bump cap nuts with rubber mallet to seat securely.
  4. Repeat process for other four predrilled holes to secure front panel and roof.
  5. Move to back panel, hold roof down at corners to fit properly. Insert rivet tapered end 3/16" x 9/16" with rubber washer, through holes and apply cap nut to rivet end under lip of roof.
  6. Using wooden block to hold rivet heads, bump cap nuts with rubber mallet to seat securely.
  7. Repeat for both sides, being sure to hold corners down for proper fit.

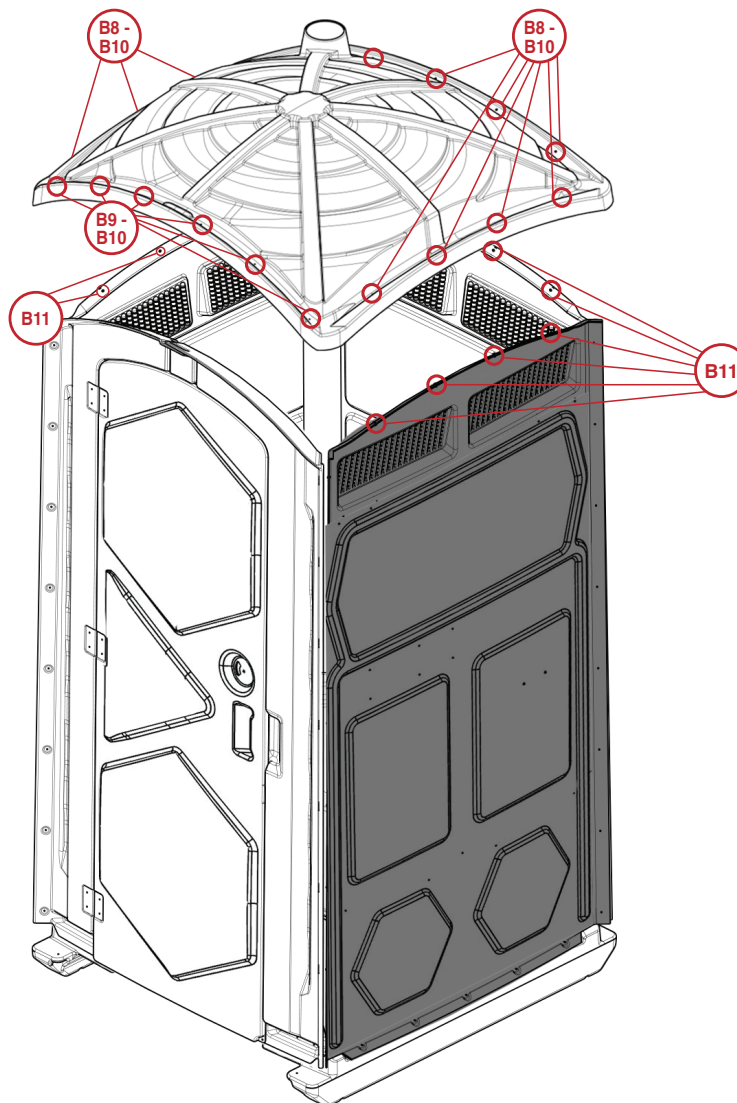

## STEP 5. SEAT TANK AND INSTALL VENT STACK

### Parts required:

- 16- #14 x 1½" gold high low thread screw
- 16- #14 x 5/8" OD bonded washer

1. Insert #14 x 1½" gold high low thread screws and bonded washers into remaining predrilled holes in panel walls at base. Secure using 3/8" nut driver.
2. With another person holding the tank securely in tank rest of base, insert #14 x 1½" gold high low thread screws with bonded washers into predetermined starts on sides and back of toilet. See pictures for start locations.
3. Push vent stack end through vent stack hole in roof. Set vent stack to desired height. Insert #14 x 1½" gold high low thread screw with bonded washer into drill start on lip of tank at vent stack, using 3/8" nut driver to secure.

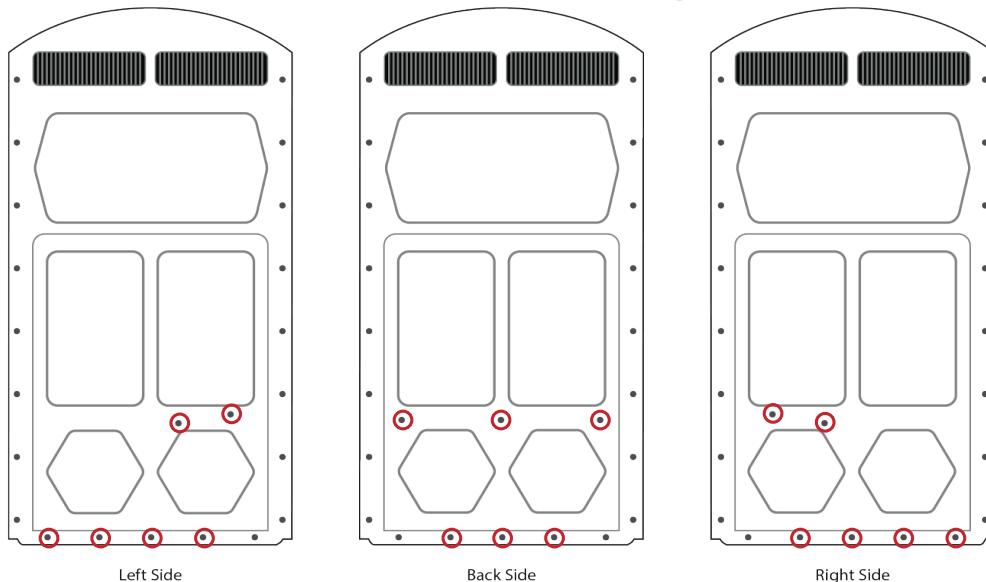
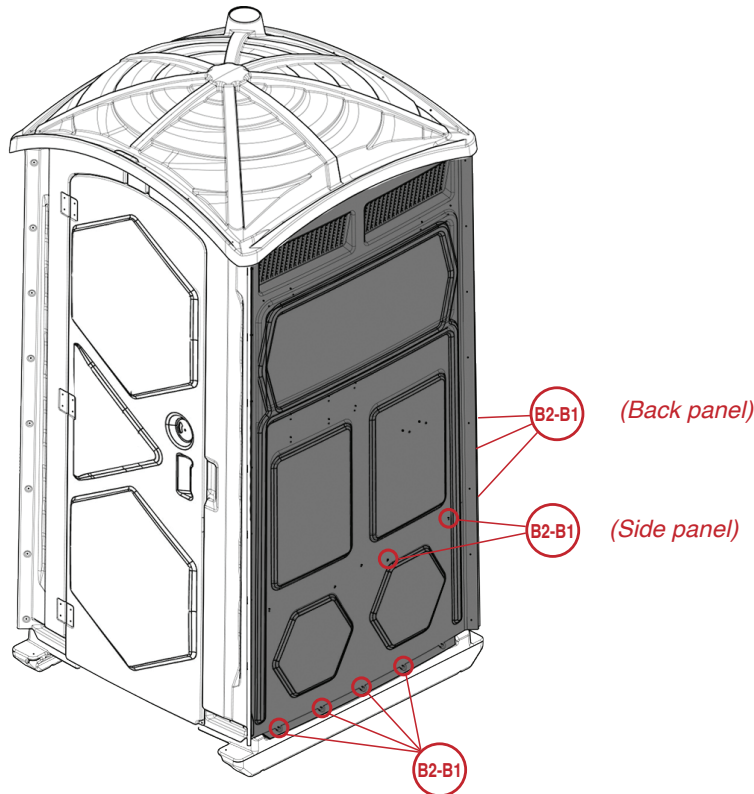

B2-B1



## STEP 6. SECURING THE URINAL

### Parts Required:

- Urinal
- 3- Rivet tapered end 3/16" x 9/16"
- 3- Cap nut push black 3/16"

1. With urinal tube inserted into small opening at front left of tank, ensure proper seating of urinal by aligning mounting hole in urinal top with pre drill marks on side panel.
2. Using 3/16" drill bit, drill holes through side panel using mounting holes in urinal as guide.
3. Insert rivets and fasten cap nuts securely on outside of toilet wall by bracing rivets with block and bumping cap nuts with rubber mallet to seat securely.

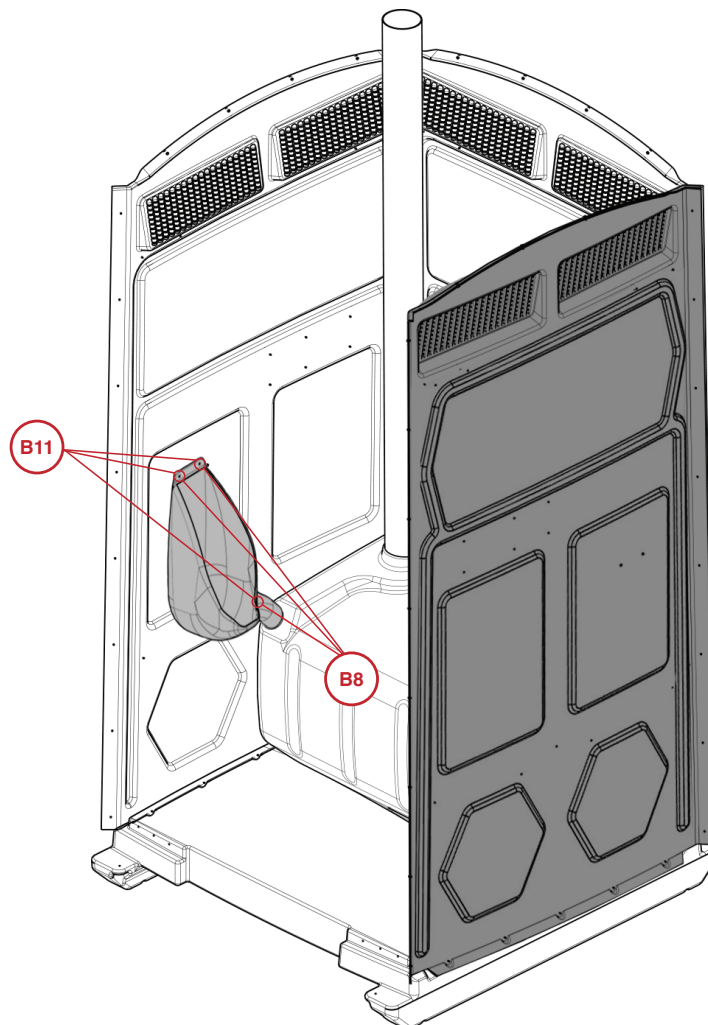

## STEP 7. INSTALLING TOILET PAPER HOLDER AND ROD.

### Parts required:

- Toilet paper holder (2 or 3 roll)
  - Toilet paper rod (2 or 3 roll)
  - 4 - Rivet tapered end 3/16" x 9/16"
  - 4 - Cap nut push black 3/16"
1. Using 3/16" drill bit, drill the predetermined holes on side panel.
  2. Align holder with holes in side panel and drill holes in holder.
  3. Insert rivets tapered end 3/16" x 9/16" through holes and attach cap nuts securely on outside of toilet wall. Bracing rivets with a wooden block, bump cap nuts with rubber mallet to seat securely.
  4. Insert toilet paper rod through holes on sides of toilet paper holder and secure with zip strap or lock of choice.

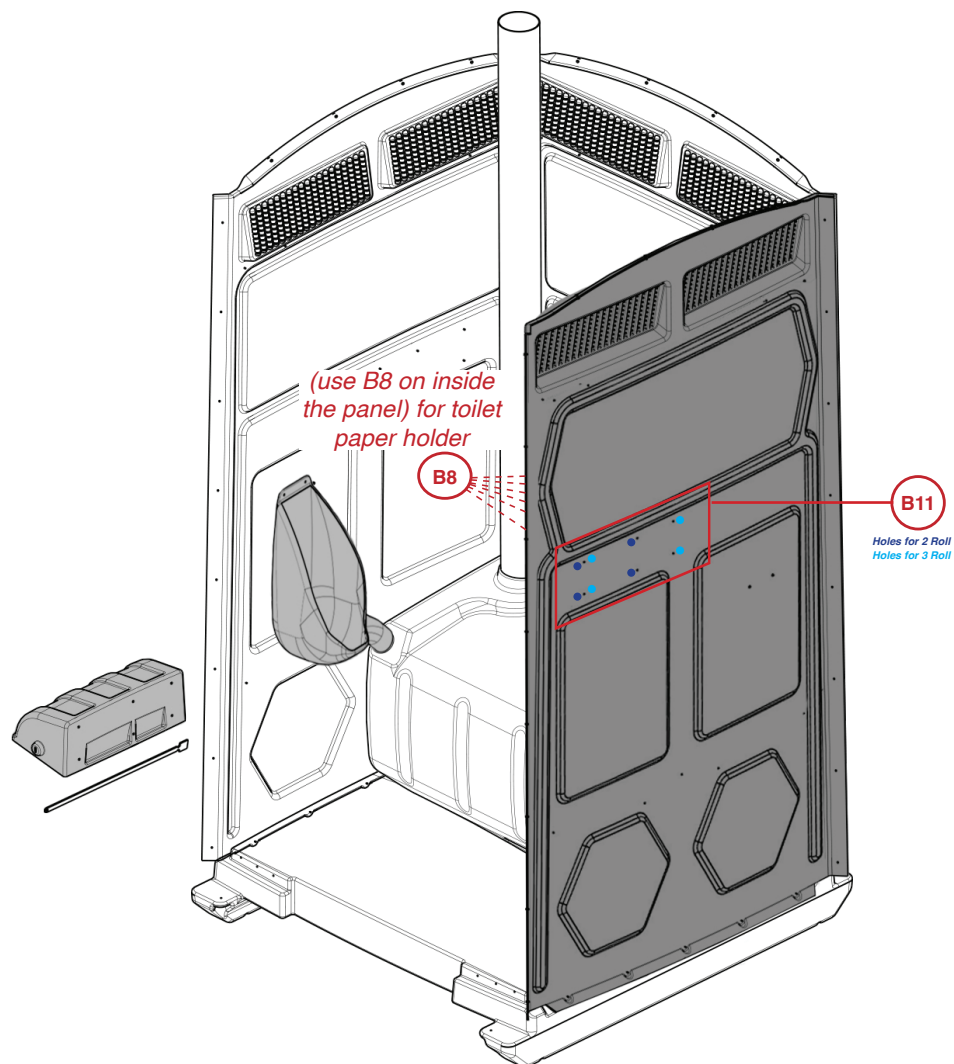

## STEP 8. INSTALLING SHELF (OPTIONAL)

### Parts required:

- Shelf
  - 4- Pop rivet 3/16"D x 3/8" G Aluminum/Steel
  - 4- Rivet washer 3/16" stainless steel
1. Using 3/16" drill bit, drill the drill start locations in back right corner of toilet just below vent screens.
  2. Insert pop rivets, from outside of toilet wall, through holes in panel and shelf. Start with holes farthest from corner.
  3. Place washer over rivet end and hold in place with screwdriver tip.
  4. Secure rivets using rivet gun.
  5. If holes closest to corner do not align properly, use 3/16" drill bit to drill from outside of toilet through holes you drilled at drill start and into shelf. Careful not to drill through shelf top.
  6. Insert rivets, from outside toilet wall, through holes in panel wall and shelf.
  7. Place washer over rivet end and secure with rivet using rivet gun.

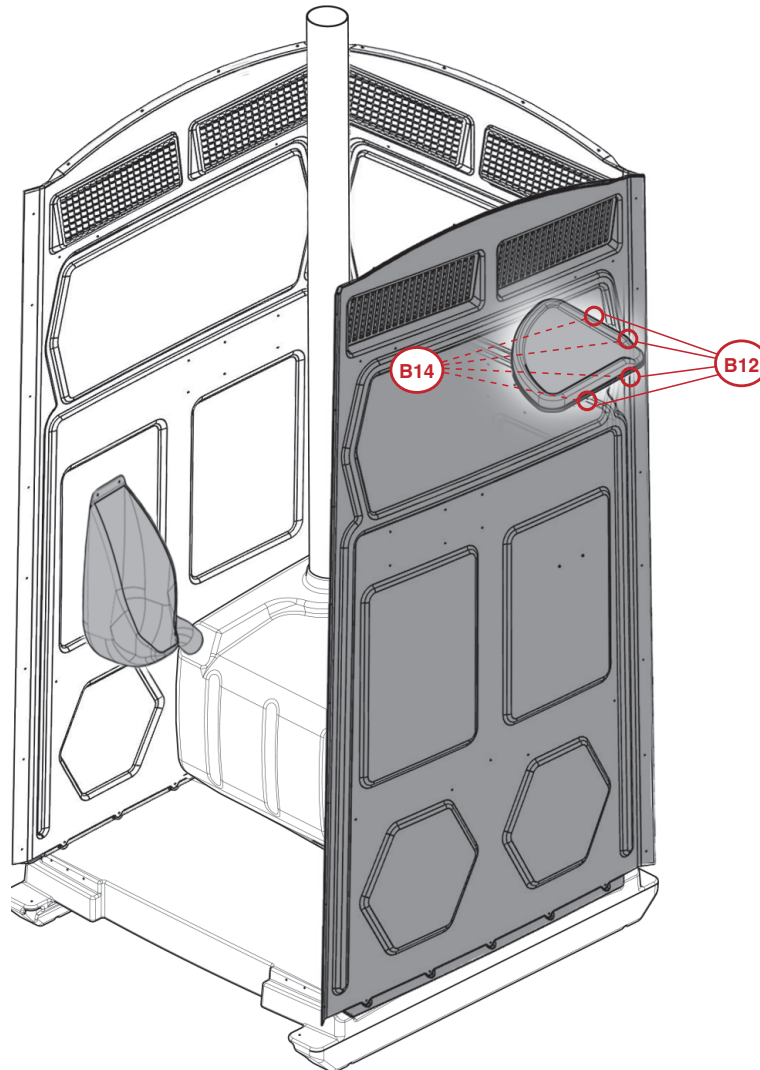

## STEP 9. INSTALLING DOOR LATCH AND MIRROR

### Parts required:

- Latch
  - Red/ Green label
  - 1/4" x 2 1/2" stainless steel bolt
  - 2- 1/4" flat stainless steel washer
  - 1/4" stainless steel lock nut
  - Mirror 5.75" x 5.75"
  - 4- mirror anchors black plastic
1. Apply red/green label to door latch so that when red shows through indicator window of door when latch is in locked position.
  2. Insert latch into door panel. Insert bolt with washer through hole in door and latch. Install other washer and lock nut.
  3. Using 7/16" nut driver, tighten lock nut while holding bolt head with 7/16" wrench.
  4. Align mirror on prepressed indentation of door and mark the hole locations.
  5. Using 1/4" drill bit drill holes for mirror. Use care to avoid drilling through front of door panel.
  6. Secure mirror using plastic mirror anchors.

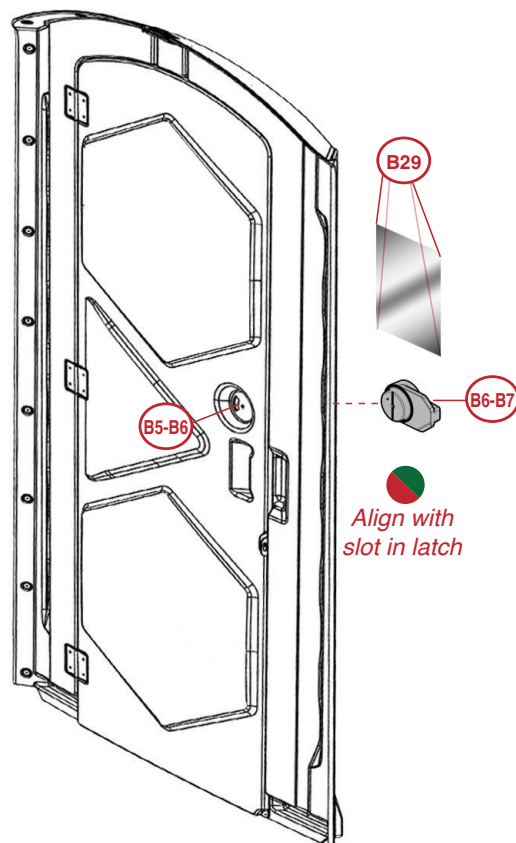



## STEP 10. INSTALLING TOILET SEAT

### Parts needed:

- Toilet seat with parts

1. Using parts, supplied with seat, attach seat to tank as instructed.

